

General Setup

From main setup menu ⑤ To enter general setup



Optional Settings

| Numeric Key | Setup Function |
|-------------|----------------|
| 1 | English UK |
| 2 | English US |
| 3 | Chinese |
| 4 | Danish |
| 5 | Spanish |
| 6 | French |
| 7 | More |

Select more for other languages



- ① Selects Mill
- ② Selects Lathe
- ③ Selects Generic



- ① Selects axis 1 and axis 2
- ② Selects axis 1 and axis 3
- ③ Selects axis 2 and axis 3



- ① Enables the axis coupling function
- ② Disables the axis coupling function



Enable or Disable Functions

| Numeric Key | Function |
|-----------------------------------|--------------------|
| 1 | Tool Offsets |
| 2 | Vector |
| 3 | Taper Angle |
| 4 | Axis Summing |
| 5 | PCD |
| 6 | Line Hole |
| 7 | More |
| press key 7 for the options below | |
| 1 | Arc Contouring |
| 2 | Polar Co-ordinates |
| 3 | Skew |
| 4 | Data Logging |
| 5 | Sub Datums |



Enter the probe diameter using the numeric keys in inch's or millimeters

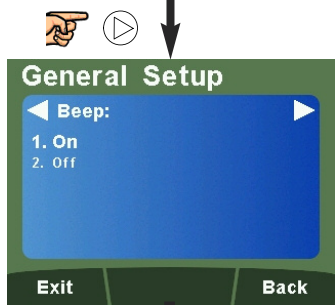

- Optional Settings**
- ① Beep on
 - ② Beep off



- ① Selects 20%
- ② Selects 40%
- ③ Selects 60%
- ④ Selects 80%
- ⑤ Selects 100%

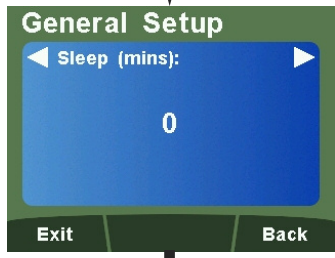

Enter using the numeric keypad the number of minutes before the sleep function operates.

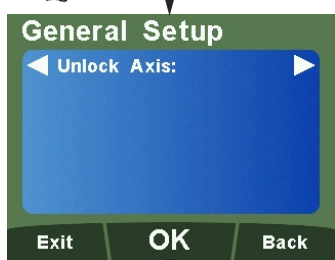

See full manual on web site for more details



See full manual on web site for more details

- Back To return to the previous menu
- OR
- Exit To return to normal operation

EUROPE
Newall Measurement Systems Ltd.
Technology Gateway, Cornwall Road
South Wigston, Leicester LE18 4XH
United Kingdom
Tel: +44 (0) 116 264 2730
sales@newall.co.uk • www.newall.co.uk

AMERICAS
Newall Electronics Inc.
USA Tel: +1 614 771 0213

CHINA & TAIWAN
Sensata Technologies China Co., Ltd.
People's Republic of China
Tel: +86 212 2306 1500

SINGAPORE AND KOREA
Sensata Technologies Co., Ltd.
Singapore
Tel: +65 647 86 867

JAPAN
Sensata Technologies Japan Ltd.
Japan
Tel: +81 45 277 7120

For more information about this or any of our products please contact us at sales@newall.com or visit www.newall.com

DP12001016ENUS
023-81450-UK/0

Sensata Technologies

NEWALL DP1200 Quick Start up Guide

For the complete manual please download from: <http://newall.com> , Click technical Support to access the download page.

Warnings

The mains supply is connected into a switch mode power supply (separate from your DP1200) via a detachable supply cord supplied. If another supply cord is used, it must have fitted a C5, 10A, EARTHED mains connector with a cord rated for at least 10A.

If a mains plug is not already fitted to the supply cord or is of the wrong type, then a suitable EARTHED plug should be used which complies with the relevant specifications for plugs and socket-outlets.

Encoder inputs 1, 2 and 3 can be used with Newall Spherosyn and Microsyn analogue encoders. Encoder input 4 can be used with Spherosyn/Microsyn or RS422 (5v TTL) **dependant on model.**

The power supply must be disconnected before opening the unit and repairs should be completed by qualified personnel.

Turn off the power by disconnecting the power supply connector, before you connect the encoder(s)

Technical Specification

| Environmental | Storage Temperature | Electrical |
|-------------------------------------------------------------------------------------------------------------------------------------------------------------------------------------------------------------------------|-------------------------------------------|------------------------------------------------------------------------------------------------|
| Operating Temperature -10°C to 50°C | Storage Temperature -20 to 70°C | EU Directive 73/23/EEC (Low Voltage Directive) BS EN 55022:1998 Class B BS EN 55024:1998 |
| Environmental Conditions - IP40 (Stand Alone) IP54 (Panel Mount) | | Input to External Switch Mode Power Supply Unit (Supplied) 100-240V (47-63Hz) |
| Relative Humidity - maximum 95% for temperature up to 31°C | | External Output voltage 15VDC |
| Disposal At the end of it's life, you should dispose of the DP1200 in a safe manner applicable to electronic goods. The case work is suitable for recycling. Please consult local regulations on disposal. | | Input Voltage to DP1200 15-24VDC ±10% |
| | | Conforms to Low Voltage Directive |

Connections

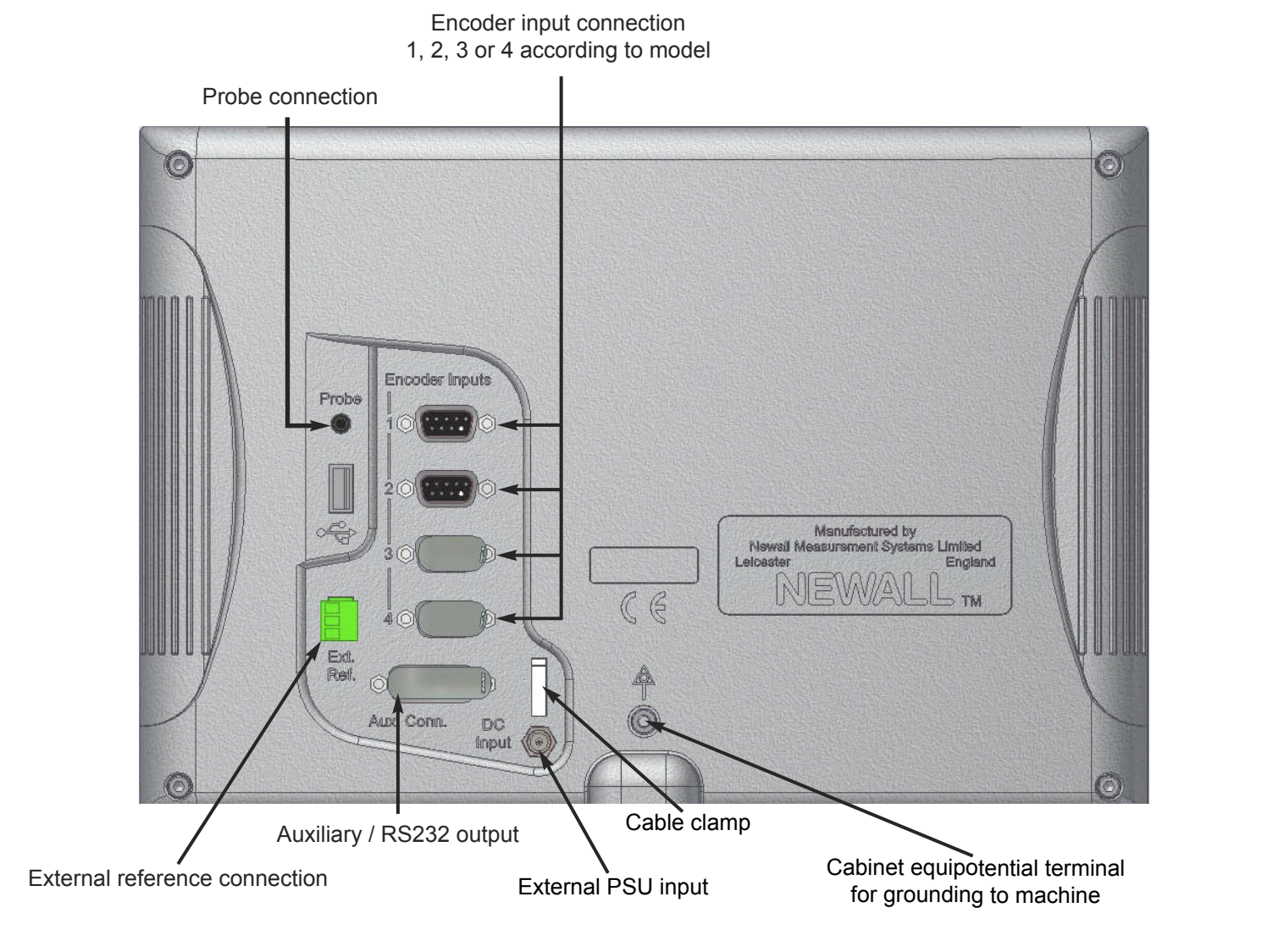

Understanding the Keypad

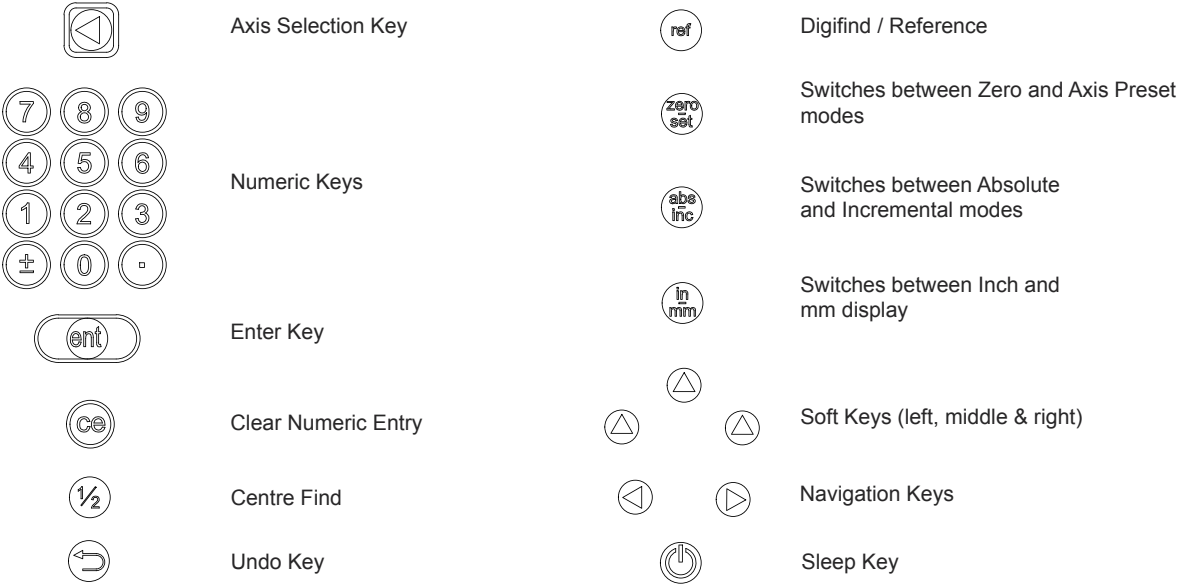

Zero an axis in Zero Mode

Ensure DP1200 is in Zero Mode. Press **zero set** and then the **Axis Selection Key** of Axis 1, 2, 3 or 4.

Zero an axis in Set Mode

Ensure DP1200 is in Set Mode. Press **zero set** and then the **Axis Selection Key** of Axis 1, 2, 3 or 4.

Preset an axis

Ensure DP1200 is in Set Mode. Press **zero set**, then **±**, then the **Axis Selection Key**, then the **Numeric Keys** (e.g., 1 4 5 0 2 3), and finally **ent**. The display shows: **-145.230**.

Entering Setup

Press **Menu**, then **9**, then **1 9 3 7**.

Axis Setup (Analogue)

Legend Setup

① To setup the 1st axis
 ② To setup the 2nd axis
 ③ To setup the 3rd axis
 ④ To setup the 4th axis

➡ Set the legend of the axis to a character from the table

| Key | 1 st Press | 2 nd Press | 3 rd Press | 4 th Press | 5 th Press |
|-----|-----------------------|-----------------------|-----------------------|-----------------------|-----------------------|
| 0 | 0 | N/A | N/A | N/A | N/A |
| 1 | X ¹ | Y ¹ | Z ¹ | 1 | N/A |
| 2 | A | B | C | 2 | N/A |
| 3 | D | E | F | 3 | N/A |
| 4 | G | H | I | 4 | N/A |
| 5 | J | K | L | 5 | N/A |
| 6 | M | N | O | 6 | N/A |
| 7 | P | Q | R | S | 7 |
| 8 | T | U | V | 8 | N/A |
| 9 | W | X | Y | Z | 9 |

Axis Setup (Analogue)

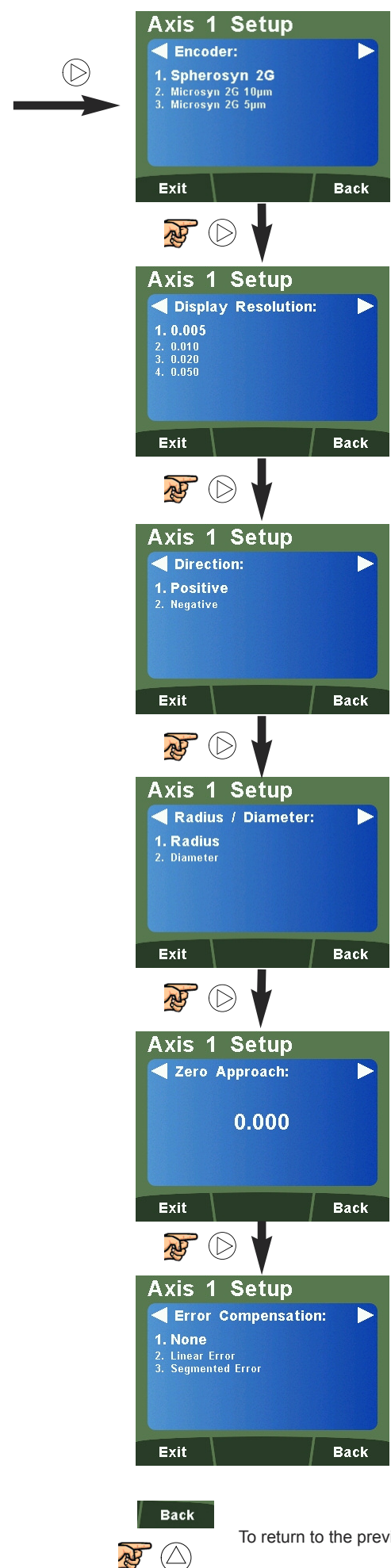

Default Settings

Spherosyn 2G

Encoder type must match to encoder in use, or the DP1200 will not measure correctly.

Optional Settings

- ① Selects Spherosyn 2G
- ② Selects Microsyn 2G (10µm)
- ③ Selects Microsyn 2G (5µm)

5µm
0.005

- | Spherosyn 2G & Microsyn 2G (10µm) | Microsyn 2G (5µm) |
|-----------------------------------|------------------------|
| ① Selects 0.005 (5µm) | ① Selects 0.001 (1µm) |
| ② Selects 0.010 (10µm) | ② Selects 0.002 (2µm) |
| ③ Selects 0.020 (20µm) | ③ Selects 0.005 (5µm) |
| ④ Selects 0.050 (50µm) | ④ Selects 0.010 (10µm) |

This is the resolution that will be used in the axis display

Positive

- ① Selects positive
- ② Selects negative

Changes the direction of travel from positive to negative or negative to positive.

Radius

- ① Selects radius
- ② Selects diameter

When set as a lathe the 1st axis is automatically set to the diameter setting.

0.000

User defined, use numeric keypad to enter value in inches or millimeters

This setting provides a visual indication when the set zero limit is passed.

See full manual on web site for more details

Back
To return to the previous menu