



DSK5HKB MODELS

FUNCTIONAL SAFETY SIL3/PLE

This Quick Installation Guide is a summary of Chapter 4 "Installation and Start Up" from the "Safety User Manual". It is used as an aid during mounting to ensure that the Sensata | BEI Sensors safety encoders are correctly incorporated into safety system loops. More detailed information is available in the Safety User Manual on request. Customer documentation (Encoder datasheet, Safety EC-Type certificate, etc.) is available for customer download on Sensata website.



SAFETY INSTALLATION REQUIREMENTS

⚠ WARNING / CAUTIONS

- The safety function requires that the four safety signals (A, A/ and B, B/ in digital or S, S/ and C, C/ in sine versions) are always connected to the safe PLC and used in the safety loop.
- Channel 0 (Z, Z/) is not part of the safety function. If Z, Z/ are not used they must be terminated through 3k0hm pull-down resistors connected to 0V.
- Good installation practice must be followed, including, but not limited to: tightening screws to proper torque, install all cover plugs correctly and never connect the encoder to power mains (115 VAC, 220 VAC)
- The safety system must be compliant with the following documents:
 - Safety Loop Prerequisites (table to the right)
 - Specifications in the Safety User Manual
- If external damage is detected on the box, inspect encoder carefully before mounting (connector, shaft, stator coupling...). Damage due to transport may lead to dangerous fault. In case of doubt, unit must be replaced.

External Safety Loop Prerequisites

Electrical Encoder Version	Positive lock	Cable break detection	Safe supply voltage with monitoring	Vector length monitoring	Speed comparison	Zero crossing detection	Inverse signal monitoring	Exclusive bit check
2WT	X	X	Y ⁽¹⁾	Y	Y	Y		
5WT	X	X		Y	Y	Y		
2G2	X	X	Y		Y		Y	Y ⁽¹⁾
5G5	X	X			Y		Y	Y ⁽¹⁾
5G2	X	X			Y		Y	Y ⁽¹⁾

X: Prerequisite for all safety levels

Y: Additional prerequisite for SIL3/PLE

⁽¹⁾ Not required for SIL3/PLE for Speed without Direction



MECHANICAL MOUNTING PROCEDURE

1. Check the driving shaft runout and tolerance: diameter X H7. - Clean the shafts interfaces (avoid particles and burrs).

2. Plug the encoder and driving shafts together.

A. For a safe mounting secure the CHc M4x25mm screw with threadlocker Loctite 243 or equivalent.

B. Tighten the M4 shaft screw with recommended torque: 3.5 N.m +/-10%.

C. Tighten the axial sealing plug for insuring the IP protection with recommended torque:

- Slotted head (for axial covers): 3 N.m +/-10%
- Hex 8mm head (for radial covers): 4 N.m +/-10%

4. Fasten the encoder on the frame

- For a safe mounting secure the screws with threadlocker Loctite 243 or equivalent.
- Check the position of the stator coupling. Avoid compressing or extending it to insure a minimal load on the bearing block.
- Tighten the 2 central or 4 shifted M3 screws at 1.8 N.m +/-10% with the ribbed lock washers.

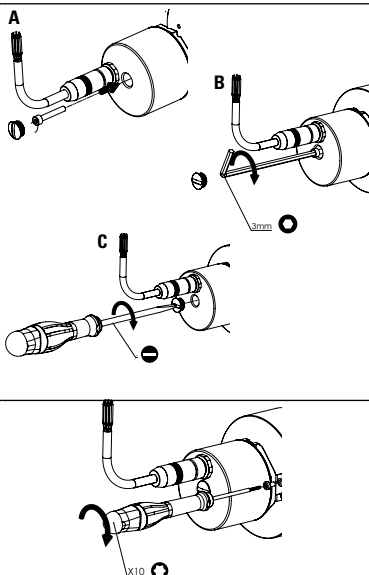

GENERAL MECHANICAL PRECAUTIONS

- Never hard couple both the body and the shaft of an encoder. Flexible couplings or other flexible mountings ensure long bearing life.
- Avoid installing with the shaft upright as water can pool around the shaft and may eventually work its way into a sealed area.
- It is good practice to use lockwashers and thread locker when mounting an encoder. Use the manufacturer's recommended torque for screws to ensure good mechanical and electrical function.
- Inspect connectors for damaged O-rings, threads or bent connector pins. Replace connector if necessary.
- Install so that the cable leads down and away from the encoder body. If the cable runs up it is susceptible to damage.
- Do not subject the encoder to excessive shock (hammering or dropping).
- Do not attempt to disassemble or modify the encoder by machining.
- Keep encoder in original package until ready for installation. Always handle product by the body, not the cable.





ENCODER EXTRACTION PROCEDURE

1-Remove the cover plug		2- Unscrew slightly the CHc M4x25mm shaft screw (1 to 2 turns only)		3- Unscrew the anti-rotation device	
4- Screw a CHc M10x30mm (mini) extraction screw into encoder shaft. Apply progressive torque until encoder releases from driving shaft		5- Remove the CHc M10 extraction screw		6- Remove the CHc M4x25mm shaft screw	



GENERAL ELECTRICAL PRECAUTIONS

Cable	<ul style="list-style-type: none"> Follow good cable installation practices, including: <ul style="list-style-type: none"> Protecting cable from cuts or abrasion Follow recommend bend radius Provide a service loop from cable to mounting clamp to avoid damage due to snagging cable Avoid coiling up excess cable – trim to proper length for the installation
Connection	<ul style="list-style-type: none"> Never connect data lines to each other or to a potential Refer to WARNINGS/CAUTIONS regarding handling of the 0 (Z and Z/) signals. Do not use the same cable for high power drive (motor drive, VFD) and encoder. Keep encoder signals separate from potential electrically interfering signals and follow proper shielding and grounding procedures. Metal connectors should have 360° shielding contact Connect each data line with its logical pair. i.e. A with A/, B with B/ and Z with Z/ in a differential receiver.
Grounding	<ul style="list-style-type: none"> Cable shield and encoder body should be connected at the same potential Do not leave the ground plane unconnected. Connect the cable shield ground to the control cabinet ground if available. Otherwise to 0V. Always ground the encoder housing to prevent electrostatic discharging through the mounting shaft.

Cable Requirements		
Supply	Output	Length
5VDC	2WTN	100 m
	2G29	100 m ⁽¹⁾
11-30 VDC	5WTN	100 m
	5G29	100 m
	5G59	100 m ⁽²⁾

⁽¹⁾ Cable > 20 m use "GP" with voltage sensing power supply.

⁽²⁾ Frequency restrictions – check "Safety User Manual"

Allowable Bend Radius		
Cable	Static	Dynamic
G3-U3	30 mm	N/R
GC	50 mm	150 mm
TE	60 mm	60 mm
GP	30 mm	90 mm

Recommended Wire Cross Section	
Power	> 0.22 mm ²
Data Signal	< 0.22 mm ²



ELECTRICAL MOUNTING PROCEDURE

- Verify that you have the correct power supply and that it is switched off prior to starting installation.
- Ensure that you have the correct wiring connections identified. Either through a sticker on the encoder or an installation manual.
- Make sure the cable run is in accordance with the tables shown in the installation guide.
- Power to the encoder and to the controller should be switched on (or off) simultaneously to ensure proper power up during initialization.

BEI Sensors SAS Sensata Technologies

Espace Européen de l'Entreprise
9, rue de Copenhague
B.P. 70044 Schiltigheim
F 67013 Strasbourg Cedex

Tél : +33 (0)3 88 20 80 80
Mail: position-info.eu@sensata.com

Sensata Technologies, Inc. ("Sensata") data sheets are solely intended to assist designers ("Buyers") who are developing systems that incorporate Sensata products (also referred to herein as "components"). Buyer understands and agrees that Buyer remains responsible for using its independent analysis, evaluation and judgment in designing Buyer's systems and products. Sensata data sheets have been created using standard laboratory conditions and engineering practices. Sensata has not conducted any testing other than that specifically described in the published documentation for a particular data sheet. Sensata may make corrections, enhancements, improvements and other changes to its data sheets or components without notice.

Buyers are authorized to use Sensata data sheets with the Sensata component(s) identified in each particular data sheet. HOWEVER, NO OTHER LICENSE, EXPRESS OR IMPLIED, BY ESTOPPEL OR OTHERWISE TO ANY OTHER SENSATA INTELLECTUAL PROPERTY RIGHT, AND NO LICENSE TO ANY THIRD PARTY TECHNOLOGY OR INTELLECTUAL PROPERTY RIGHT, IS GRANTED HEREIN. SENSATA DATA SHEETS ARE PROVIDED "AS IS". SENSATA MAKES NO WARRANTIES OR REPRESENTATIONS WITH REGARD TO THE DATA SHEETS OR USE OF THE DATA SHEETS, EXPRESS, IMPLIED OR STATUTORY, INCLUDING ACCURACY OR COMPLETENESS. SENSATA DISCLAIMS ANY WARRANTY OF TITLE AND ANY IMPLIED WARRANTIES OF MERCHANTABILITY, FITNESS FOR A PARTICULAR PURPOSE, QUIET ENJOYMENT, QUIET POSSESSION, AND NON-INFRINGEMENT OF ANY THIRD PARTY INTELLECTUAL PROPERTY RIGHTS WITH REGARD TO SENSATA DATA SHEETS OR USE THEREOF.

All products are sold subject to Sensata's terms and conditions of sale supplied at www.sensata.com SENSATA ASSUMES NO LIABILITY FOR APPLICATIONS ASSISTANCE OR THE DESIGN OF BUYERS' PRODUCTS. BUYER ACKNOWLEDGES AND AGREES THAT IT IS SOLELY RESPONSIBLE FOR COMPLIANCE WITH ALL LEGAL, REGULATORY AND SAFETY-RELATED REQUIREMENTS CONCERNING ITS PRODUCTS, AND ANY USE OF SENSATA COMPONENTS IN ITS APPLICATIONS, NOTWITHSTANDING ANY APPLICATIONS-RELATED INFORMATION OR SUPPORT THAT MAY BE PROVIDED BY SENSATA.
Mailing Address: Sensata Technologies, Inc., 529 Pleasant Street, Attleboro, MA 02703, USA.

CONTACT US

Americas
+1 (800) 350 2727
sensors@sensata.com
Europe, Middle East & Africa
+33 (3) 88 20 8080
position-info.eu@sensata.com
Asia Pacific
sales.isasia@list.sensata.com
China +86 (21) 2306 1500
Japan +81 (45) 277 7117
Korea +82 (31) 601 2004
India +91 (80) 67920890
Rest of Asia +886 (2) 27602006
ext 2808